

**YRMC Del E. Webb Outpatient Center** is located at  
3262 N. Windsong Drive, Prescott Valley, AZ 86314

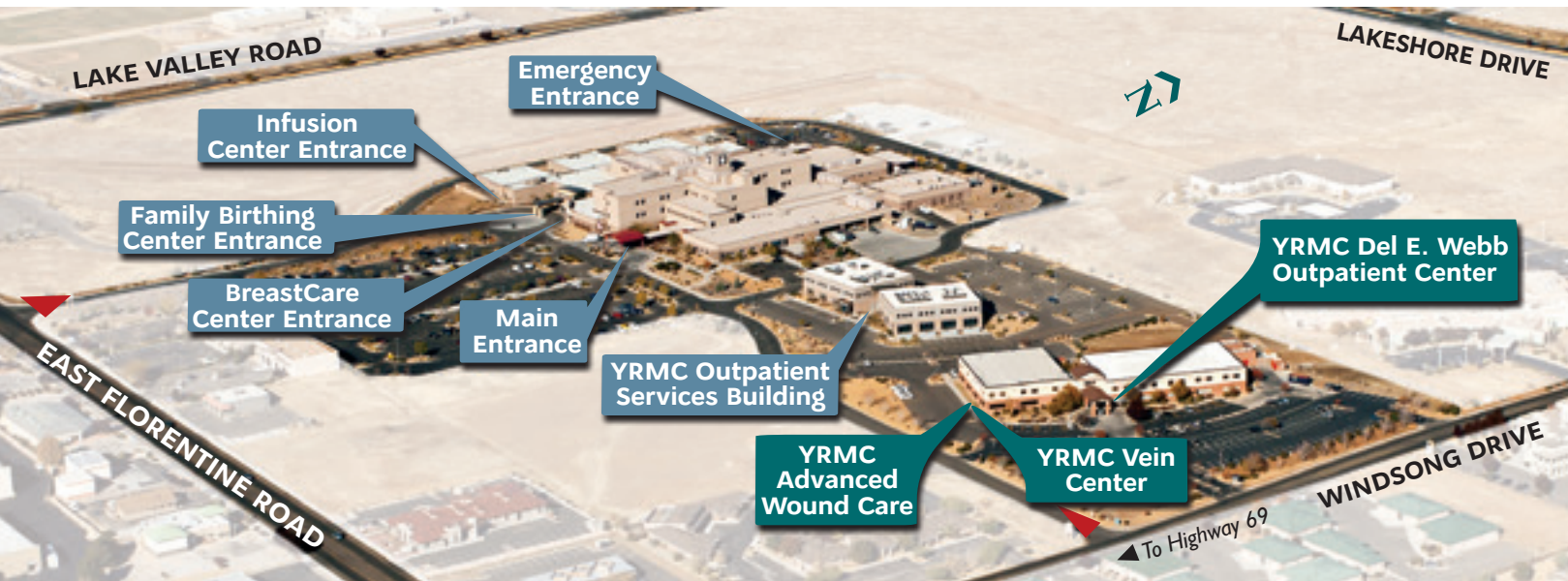

Preventive Medicine: (928) 759-5920  
Physical Rehabilitation: (928) 759-5940  
Patient Financial Services: (928) 771-5151  
Family Resource Center: (928) 771-5651  
Advanced Wound Care: (928) 771-4788  
The Vein Center: (928) 759-5890

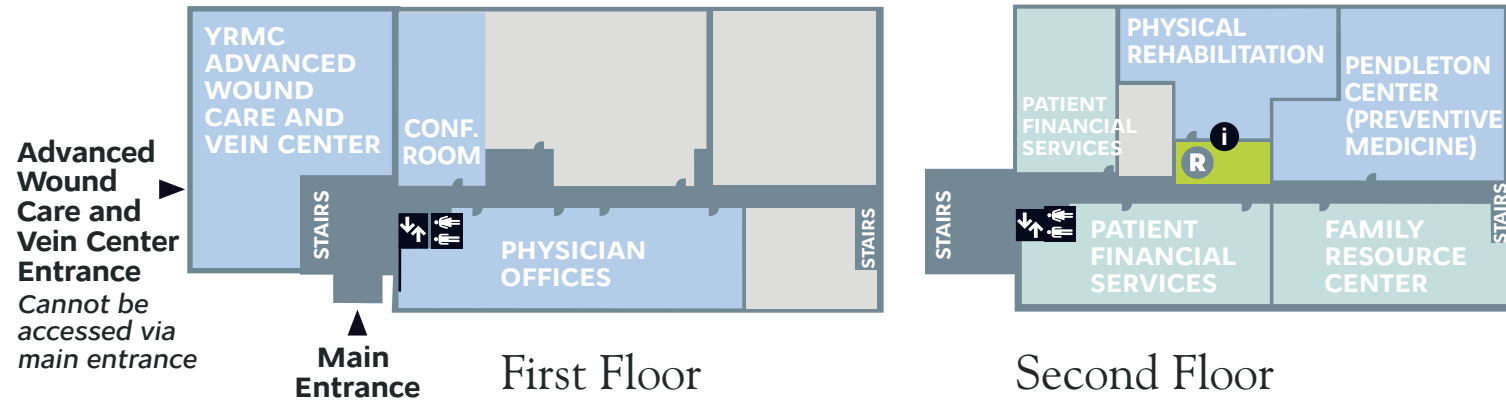

**WEST CAMPUS** 1003 WILLOW CREEK ROAD, PRESCOTT, AZ 86301  
**EAST CAMPUS** 7700 EAST FLORENTINE ROAD, PRESCOTT VALLEY, AZ 86314

YRMC.org YRMCHealthConnect.org Find us on Facebook YouTube Twitter

# LOCATION GUIDE

## Yavapai Regional Medical Center East



### Welcome to Yavapai Regional Medical Center East

Yavapai Regional Medical Center (YRMC) is a progressive community healthcare system dedicated to providing a wide range of healthcare and human services for the residents and visitors of Yavapai County.

Working together at YRMC, we are committed to creating a total healing environment and achieving the highest level of patient satisfaction.

Yavapai Regional Medical Center sincerely cares about the health of our patients, their loved ones, as well as

that of all our visitors and staff. Since the health of each person matters greatly to us, we ask that you do not smoke or use tobacco products on our campus.

Thank you for helping us create the healthiest environment possible for our patients, visitors and staff!

**Please ask our volunteers if you would like assistance in finding your way around the hospital. We are glad to help!**



YAVAPAI REGIONAL  
MEDICAL CENTER

# YRMC East First Floor

- |                        |                   |                                               |
|------------------------|-------------------|-----------------------------------------------|
| Emergency              | BreastCare Center | ↑↓ Elevators                                  |
| Admitting/Registration | Chapel            | ♂♀ Restrooms                                  |
| Cardiopulmonary        | Waiting Area      | R Reception Area                              |
| Radiology              | Gift Shop         | ☕ Coffee Shop                                 |
| Surgery                | Cafeteria/Dining  | i Information/Reception                       |
| Laboratory             | Administration    | 📶 YRMC Guest Wireless Available Hospital-wide |
| Pharmacy               |                   |                                               |

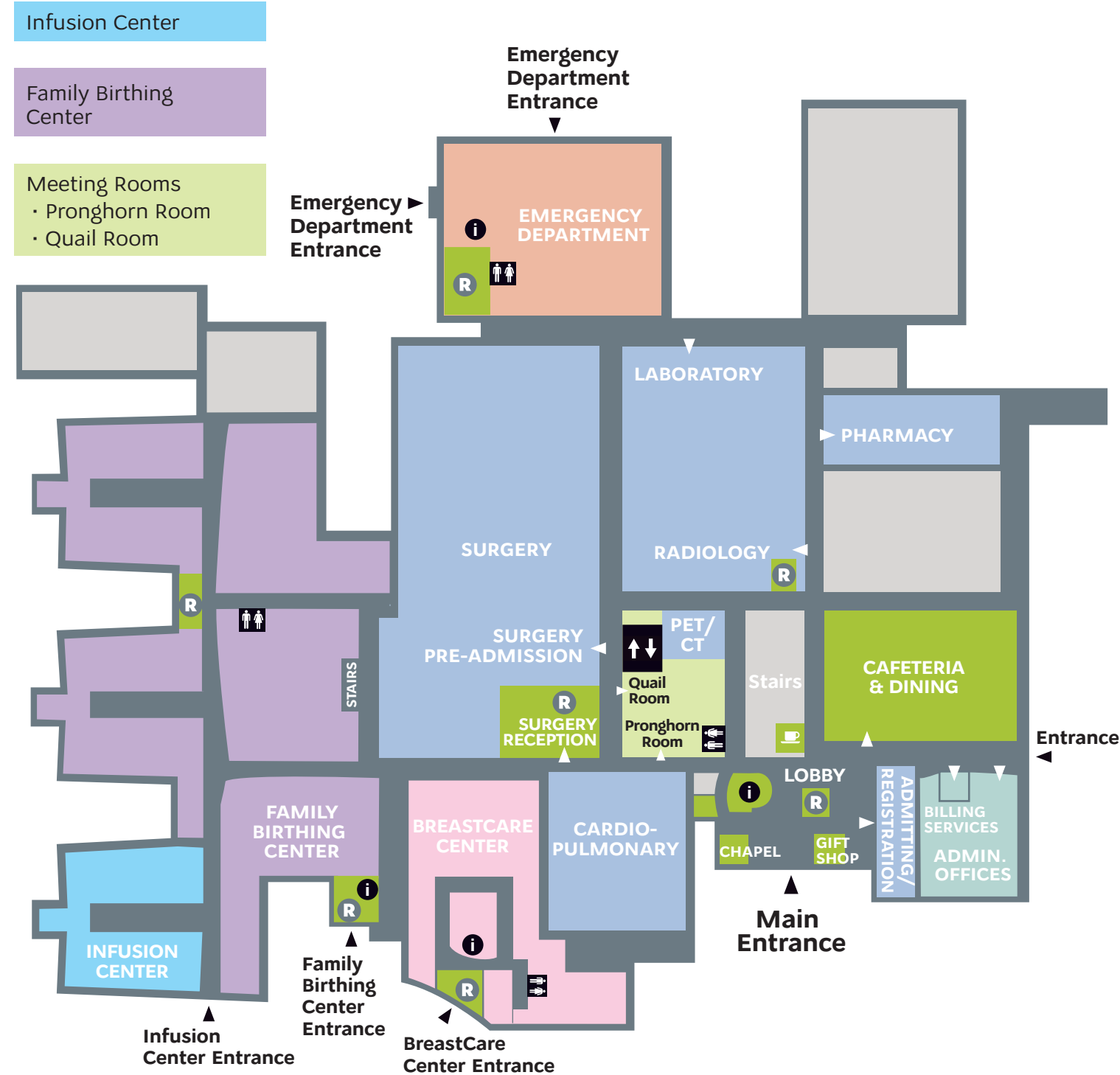

# Second Floor

- |               |                    |             |
|---------------|--------------------|-------------|
| Patient Rooms | • Medical/Surgical | • Telemetry |
| MCU           |                    |             |
- 
- |                                               |
|-----------------------------------------------|
| ↑↓ Elevators                                  |
| ♂♀ Restrooms                                  |
| R Reception Area                              |
| i Information/Reception                       |
| 📶 YRMC Guest Wireless Available Hospital-wide |

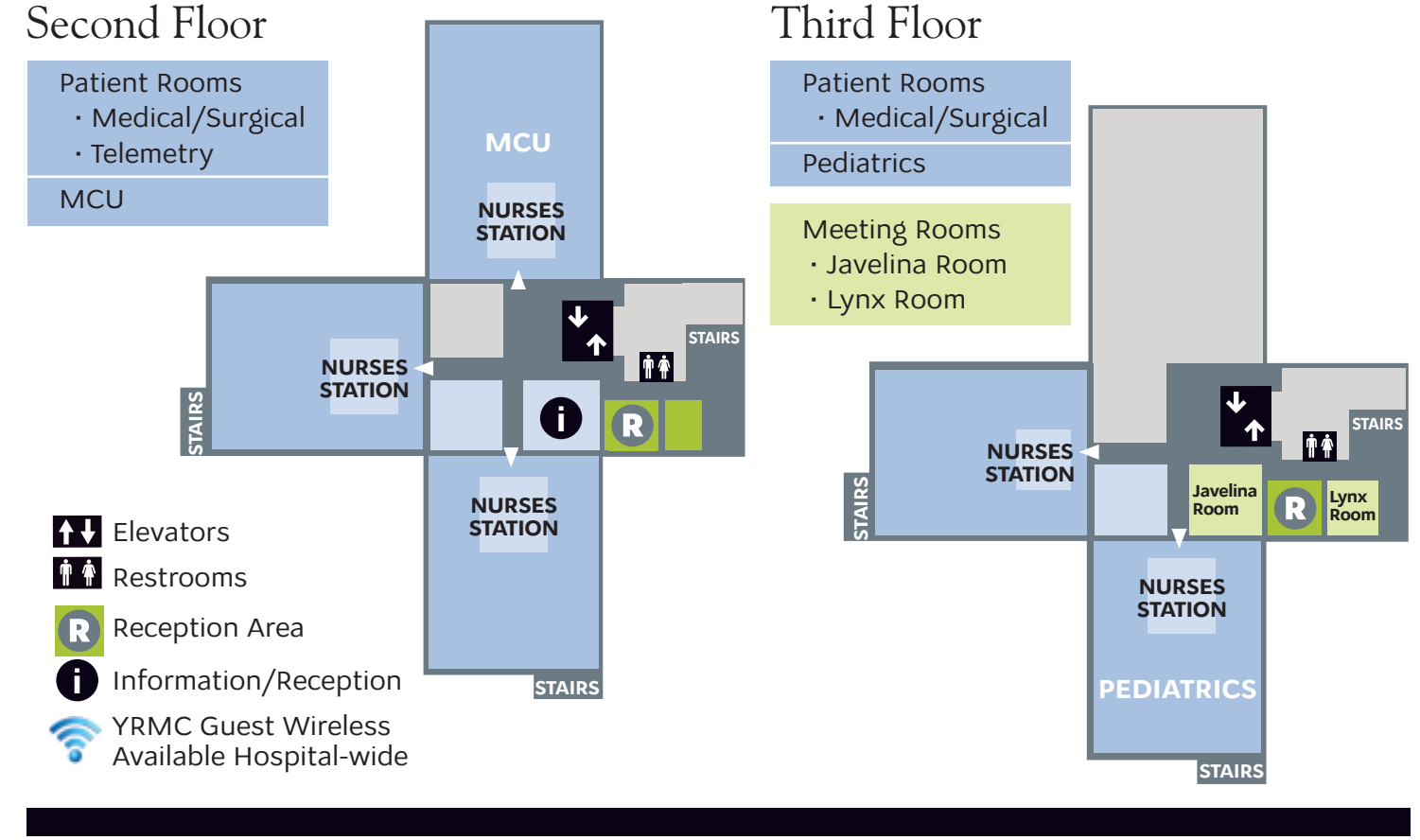

# Third Floor

- |               |                    |
|---------------|--------------------|
| Patient Rooms | • Medical/Surgical |
| Pediatrics    |                    |
- 
- |               |                 |             |
|---------------|-----------------|-------------|
| Meeting Rooms | • Javelina Room | • Lynx Room |
|---------------|-----------------|-------------|
- 
- |                                               |
|-----------------------------------------------|
| ↑↓ Elevators                                  |
| ♂♀ Restrooms                                  |
| R Reception Area                              |
| i Information/Reception                       |
| 📶 YRMC Guest Wireless Available Hospital-wide |

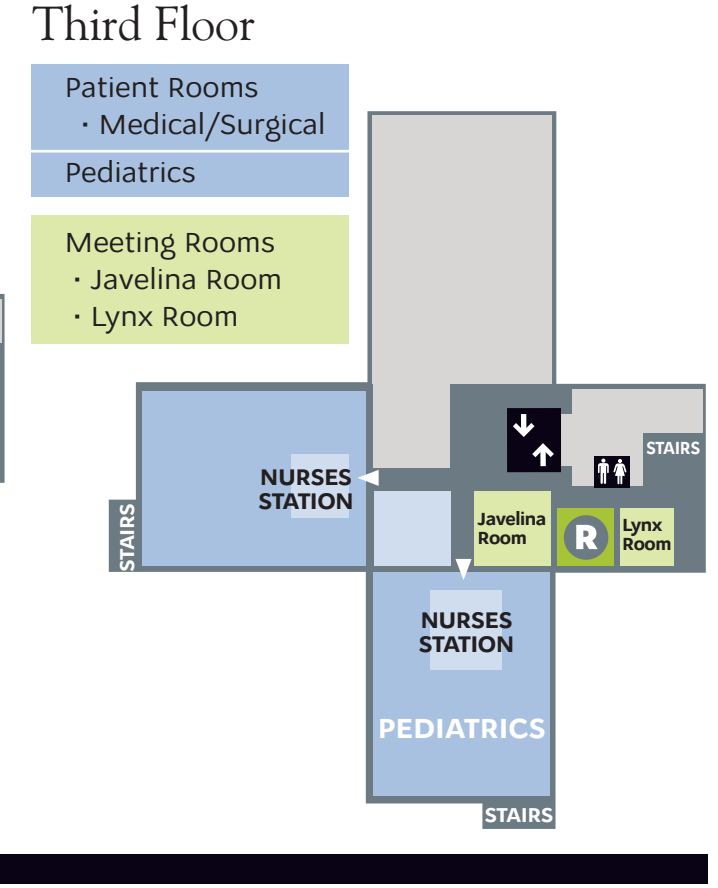

**YRMC Outpatient Services Building** is located at 7700 East Florentine Road, Building B, Prescott Valley, AZ 86314



- YRMC PhysicianCare Primary Care: (928) 442-8710
- YRMC PhysicianCare Cardiology: (928) 442-8117
- YRMC PhysicianCare Breast Surgery: (928) 442-8740
- Prescott Valley Cardiac Diagnostics: (928) 442-8195
- Prescott Valley Medical Imaging: (928) 771-7577
- YRMC Outpatient Clinical Laboratory: (928) 759-5800

